

Deja Vu

Sink Mixer

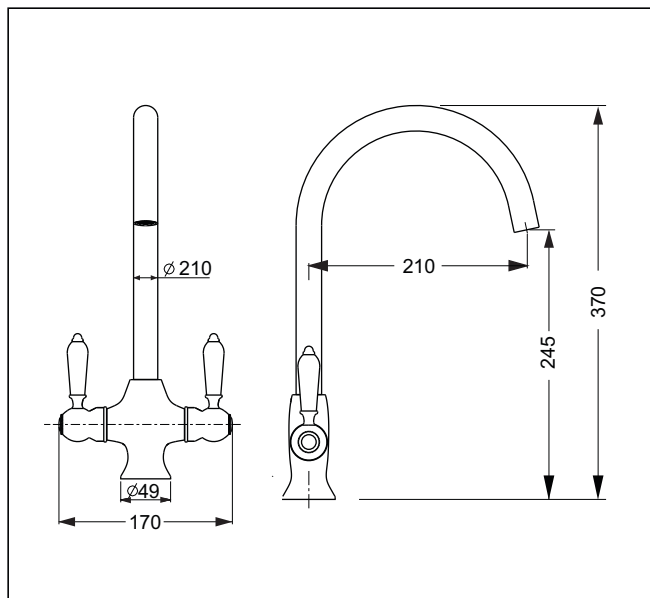

Code: DJ SM CH	DJ SM RG	DJ SM GO	DJ SM BLK	DJ SM BN
Finish: Chrome	Rose Gold	Gold	Chrome Black	Brushed Nickel

Mechanism: 90° Ceramic mechanisms - left & right handed

Spout: Swivel 360°

Body: Plated brass

Handle: 2 ceramic swing arms

Water Inlet: via 1/2" BSP female. 2 x M10 flexi tails

Water Outlet: 21.5ml cache style PCA 8

Mounting: Mounting Hardware: 32mm threaded tube

Base seal - O-ring: 2.62 X 40.95

Maximum bench thickness: 42mm

Flow Control: PCA 8 fitted for regulated flow with mains pressure system

Hot @ 35kPa = 5.6 l/min

Suitable for mains pressure only

Recommended Operational Pressure Range: 150 - 600 kPa
Maximum Operating Temp: 80°C Never to Exceed: 1000 kPa



aquatica



KIWI OWNED COMPANY

NZ • DESIGNED
• ASSEMBLED
• TESTED

Aquatica NZ Limited

9 Saunders Place,
Avondale, Auckland.
Tel: 09-828 2068,
Fax: 09-828 2069
Email: info@aquatica.co.nz
or visit our website:
www.aquatica.co.nz

© copyright Aquatica 2019

Please note: Specifications are subject to change without notice. It is the responsibility of the installer to check the measurements of the physical product before installation