

CABINET SPECIFICATION  
City 46 - 1200 - Floor - DB - 4 Drawer

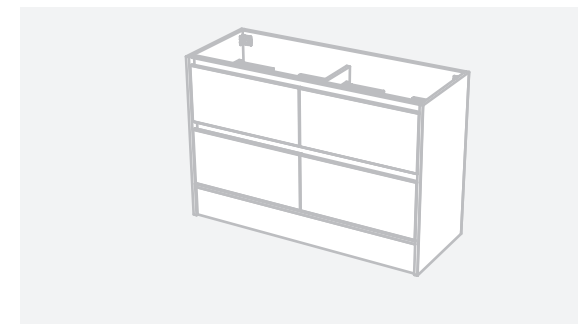

Basin range (refer to applicable basin specification)

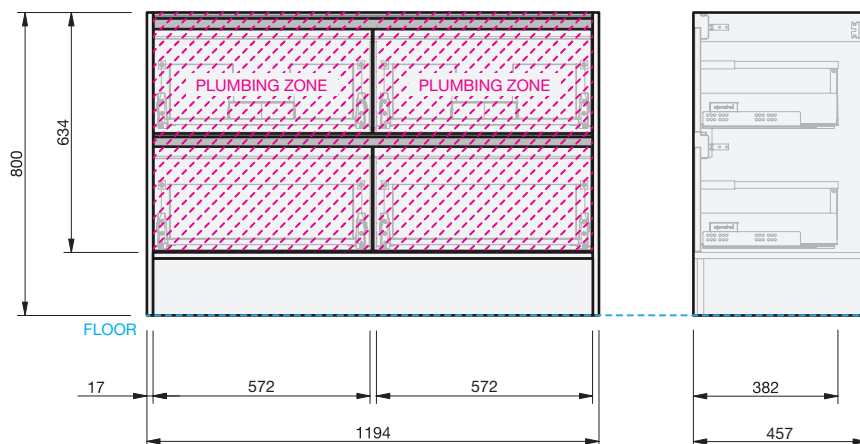
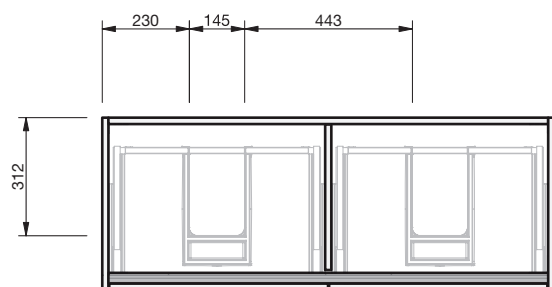

- Drawings depict cabinet only.
- Waste outlet positioned for standard bottle trap and pop up basin waste.
- Onda Storage Type A supplied with vanity.



INDICATES PLUMBING -----

INDICATES FLOOR SURFACE -----

IMPORTANT NOTE: Throughout this guide, dimensions may vary by  $\pm 2$ mm. Please read the installation manual for detailed information on installing the product. St. Michel pursues a policy of continuing improvement in design and manufacturing of its products. The right is therefore reserved to vary specifications without notice. For full installation instructions visit [stmichel.co.nz](http://stmichel.co.nz).

Date edited:

20/04/2020

01/01