

DESCRIPTION

Cangas 600 Wall-Hung Vanity - 2 Drawers, White / Melamine

PRODUCT CODE

CAD60D2WH /
CAD60D2WHM



FEATURES

- Dimensions: W600 x H638 x D455 mm
- Available in 2 drawer/single bowl, widths: 600, 800, 1000, 1200mm and 4 drawer/double bowl, widths: 1200 & 1400mm.
- Ceramic top with overflow from Europe.
- Available in White or Melamine.
- White Paint - The paint used on our products is polyurethane or UV based. It is five times harder and more durable than lacquer finishes.
- Melamine - Our wood grain melamine is a low-pressure laminate.*
- Soft-close drawers. New drawer heights offer storage variations.
- Rail options include Silver or Black Aluminium rail. Semi handle (H2) available at an additional cost.

PAINT / MELAMINE FINISHES*



White Paint



Nordic Ash

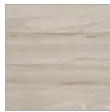

Driftwood

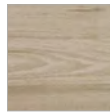

French Oak



Manhattan
Elm



Southern
Oak



Charred
Oak

NOTES

*Non-stock item.

Excludes tap ware & accessories. See reverse page for technical drawings.

DESCRIPTION

Cangas 600 Wall-Hung Vanity - 2 Drawers, White / Melamine

PRODUCT CODE

CAD60D2WH /
CAD60D2WHM

TECHNICAL DRAWINGS

Top

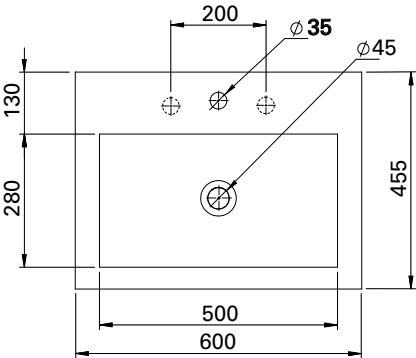

Side Section of Basin (AA)

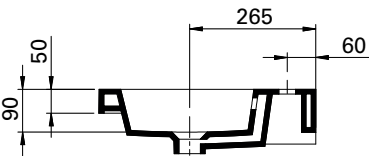

Front

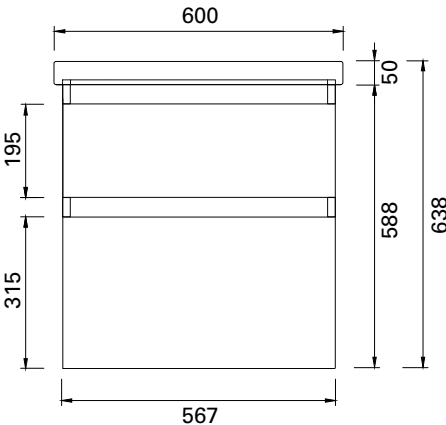

Side

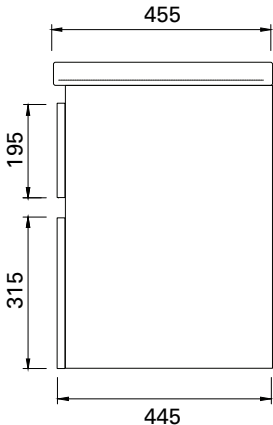

Back of Basin

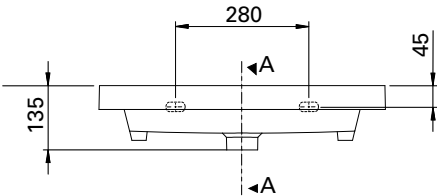

NOTES

Drawing indicates the technical measurement only and is not a reflection of how the unit will look. Sizes are nominal only. All drawings in millimeters. Drawings not to scale.