

The IXL Ventair Easy Duct has been designed to exacting standards to give you many years of trouble free operation. To ensure you get the most from your Ventair there are a few simple points to keep in mind.

### VENTILATION

To ensure optimum performance of the exhaust fan, it is essential that there is adequate air flow into the room to help the Ventair's powerful and efficient ducted fan to quickly remove steam and fumes. Ensure adequate inlets exist through windows, vents or under the door. Air flow path from inlet to fan should ideally pass over the steam or cooking fume source.

If the inline exhaust is used in a room where there is any fuel burning appliances, such as a stove or fireplace, please ensure there is adequate ventilation to ensure the entry of clean air into the room and prevent the backflow of exhaust gases.

### CLEARANCE

The Ventair Inline exhaust is designed to fit a ceiling cavity or between floor space with a minimum height of 230mm.

### INSTALLATION

- A switched power outlet/ supply is required for the Ventair Inline Exhaust - model 10380 & 10383 (Aust and NZ). This switched power supply must be in accordance with AS/NZS 3000 (Wiring Rules) or equivalent for your particular area.
- For installations in the Eire and UK markets this product should be wired to a suitable terminal block as per local wiring rules. Ensure that Class II rating is maintained
- Locate where the inlet and outlet grilles are to be located. Ensure that there is a clear path for the 150 mm diameter flexible ducting to the grille positions.
- Cut 160mm holes for the inlet and outlet grilles.
- Fit the inlet grille base into the ceiling.
- Fit backdraft flaps to Ventair blower, **ENSURE FLAPS ARE MOUNTED AT BLOWER OUTLET.**
- Locate the blower unit at the highest position in the ducting system. The blower unit may be fixed by means of suitable fasteners such as screws to a support straddling two ceiling joists suitably supported by vibration isolating material such as soft rubber matting or an insulation batt, or by suspending it from the roof rafters with straps. See figures 1, 2.
- Ensure that the Ventair blower is orientated in the correct direction. Refer to arrow on side of unit.
- Measure the length of ducting between the grilles to the blower unit and cut the ducting to length.
- **WHEN INSTALLED THE DUCTING SHOULD BE STRETCHED STRAIGHT.** Do not use longer ducting than necessary as excess length will reduce the airflow delivery. Ensure ducting at outlet of blower does not interfere with backdraft flaps
- Tape the ducting to the inlet and outlet grilles. If the outlet grille is located in the eaves it may be necessary to pass the ducting out through the hole, tape it to the grille base and then fit the grille base in the hole.
- Fit grille louvres to the grille bases.
- This appliance must be mounted with the lowest point at least 2.1m from the floor.
- **TO ENABLE SERVICE, ACCESS TO THE INLINE BLOWER MUST BE PROVIDED.**

### SAFETY NOTES

- This appliance is not intended for use by persons (including children) with reduced physical, sensory or mental capabilities, or lack of experience and knowledge, unless they have been given supervision or instruction concerning use of the appliance by a person responsible for their safety.
- Young children should be supervised to ensure they do not play with the appliance.

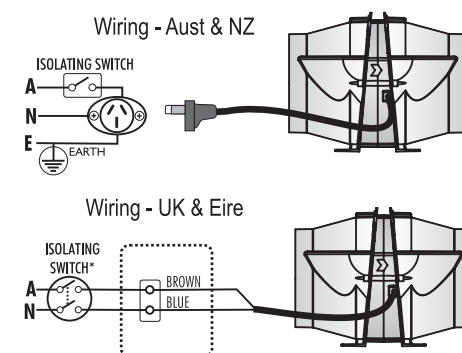
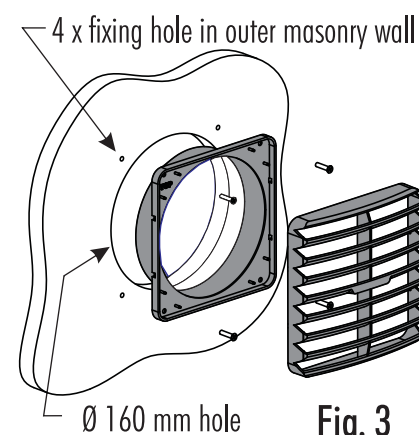
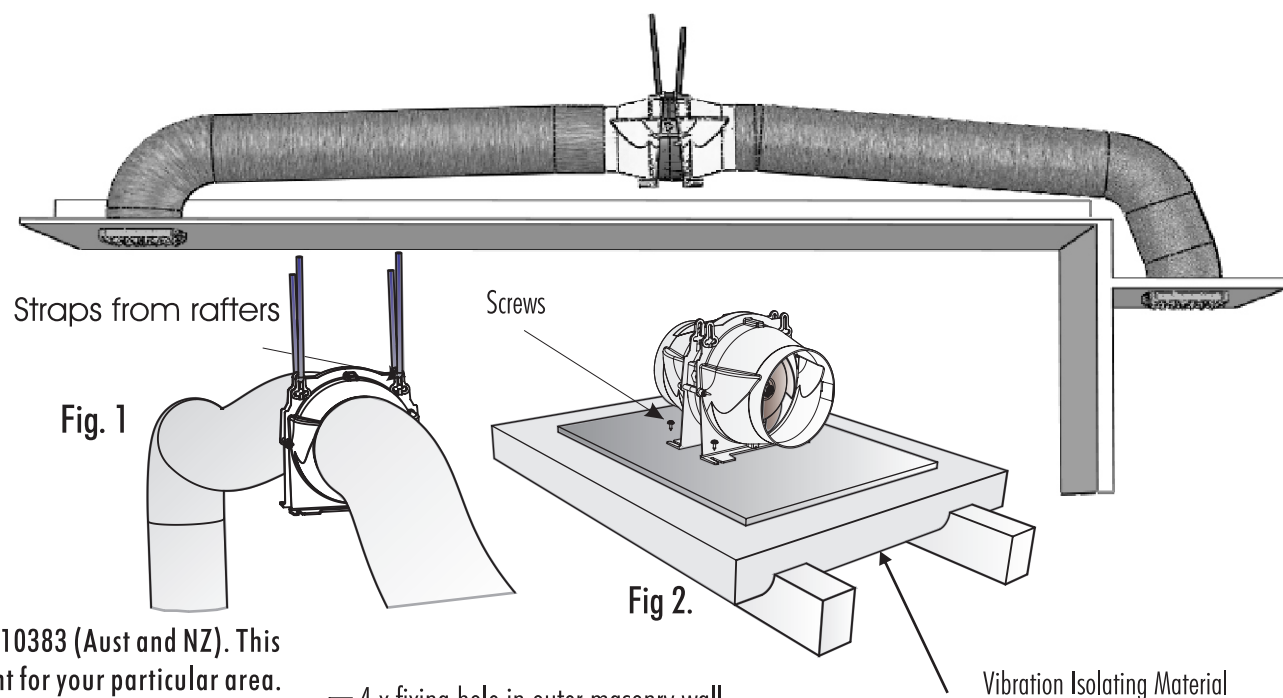

### SERVICE

For comments, questions or warranty matters:

Sampford IXL Pty Ltd

Service Department

421 Smith St

Fitzroy Victoria 3065 Australia

Phone: 1300 727 421

Fax: 1300 727 425

[aftersaleservice@sampfordixl.com.au](mailto:aftersaleservice@sampfordixl.com.au)

[info@sampfordixl.com.au](mailto:info@sampfordixl.com.au)

[www.sampfordixl.com.au](http://www.sampfordixl.com.au)

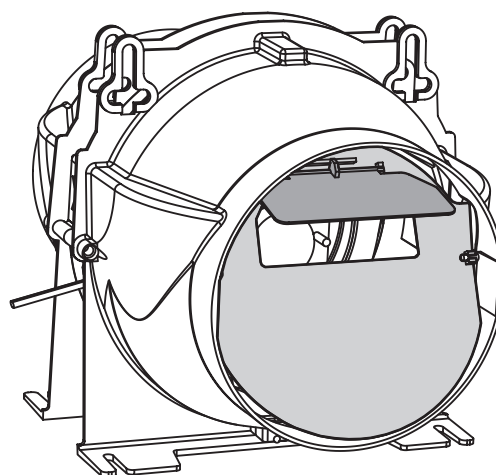

MODEL	10380	10383
HEIGHT	215mm	215mm
LENGTH	272mm	254mm
RATING	40 W	75 W
AIRFLOW	55 l/s	96 l/s

This product complies with EU Directives 2002/96/EC and 2002/95/EC.

The crossed-out dust bin symbol reported on the appliance indicates that the appliance must be disposed of separately from other domestic refuse at the end of its useful life. It must therefore be delivered to a waste recycling centre specifically for electric and electronic equipment or returned to the retailer at the moment of purchase of a new equivalent appliance. The user is responsible for delivering the appliance to the appropriate collection centre at the end of its useful life. Failure to do so may result in a fine, as provided by laws governing waste disposal. Differential collection of waste products for eventual recycling, treatment and environment and health, and also enables the materials making up the product to be recycled.

For more detailed information on the available refuse collection systems, refer to the local Municipal Solid Waste disposal centre or the shop where the product was purchased.

Producers and importers are responsible for fulfilling their obligations as regards to recycling, treatment and environmentally friendly disposal by direct or indirect participating in the collection system.

**TWO YEARS REPLACEMENT WARRANTY**

This Warranty against defects for your newly purchased IXL product is proudly prepared by Sampford IXL Pty Ltd of 421 Smith Street, Fitzroy, VIC 3065, phone 1300 727 421.

1. Sampford IXL Ventilation products come with guarantees that do not exclude the following consumer entitlements under the Australian Consumer Law:

a. replacement or refund for a major failure and compensation for any other reasonably foreseeable loss or damage; and

b. to have the goods replaced if goods fail to be of acceptable quality and the failure does not amount to a major failure.

2. Sampford IXL warrants that your product and related supply will be free from defects in materials and workmanship during the warranty term. Your warranty term is two years commencing from the date of purchase.

3. Subject to Point 1, Sampford IXL will provide a replacement of an equivalent current model where the balance of the warranty period from the original date of purchase will take effect.

4. To the fullest extent permitted by law and subject always to Point 1, Sampford IXL will not be liable for:

a. any loss or damage arising from loss of use, loss of profits or revenue; or

b. for any indirect or consequential loss or damage resulting from any breach of this warranty against defects.

5. Defective Sampford IXL products may be repaired using refurbished parts or if required, completely replaced by a refurbished product of the same type.

**Limitations to Your IXL Warranty**

6. Subject to Point 1, this Warranty:

a. will only be provided to the original purchaser where the original purchase was made from a Sampford IXL Authorised Dealer or Reseller and proof of such purchase can be presented at the time of service;

b. only applies to Sampford IXL products purchased in Australia from a Sampford IXL Authorised Dealer or Reseller and installed by a qualified person where a Certificate of Compliance in accordance with State/Territory laws is provided;

c. will not apply where the defect in or failure of the product is attributable to misuse, abuse, accident or non-observation of the manufacturer's instructions. This product must be used in accordance with the manufacturer's instructions;

d. will not cover faults due to normal wear and tear with reasonable use nor consumable components such as globes, filters, glass items, etc;

e. will not cover any damages or problems caused to this product by natural forces eg. storm, fire, flood, and earthquake; or by intrusion or accumulation (or both) of foreign matters eg. dust, soil, and moisture. Sampford IXL recommends that you take out appropriate insurances to protect your product to this end;

f. will not apply if this product is installed in a mobile dwelling eg. caravan or boat;

g. will not apply if this product is removed from the location where it was first installed;

h. is immediately void if the serial or model number label is removed or defaced;

i. is immediately void if the product is serviced or repaired by an unauthorised/unqualified personnel;

j. covers use of this product for domestic use only;

k. will not be restarted or extended upon repair or replacement of the product or a part.

**How to make a Claim under Your IXL Warranty**

7. To make a claim under this Warranty you will need to:

a. contact Sampford IXL service department on 1300 727 421 or [aftersalesservice@sampfordixl.com.au](mailto:aftersalesservice@sampfordixl.com.au) to provide details and register your claim enabling a Sampford IXL assessment;

b. submit proof of purchase with your claim eg. tax invoice or purchase receipt;

c. where a property has been constructed by a builder/developer and it is fitted with IXL products, please submit proof of purchase by way of the certificate of occupancy, with your claim.

8. Subject to Point 1, you will be responsible for any costs relating to the provision of your product to a Sampford IXL Authorised Service Dealer.

9. Subject to Point 1, in the event you live more than 50 km from a Sampford IXL Authorised Service Dealer you may be subject to travel or transport costs to facilitate the repairing or replacement of your IXL product.

10. Sampford IXL and its Authorised Service Dealers reserve the right to seek reimbursement of any costs incurred by them should your IXL product be found to be in good working order.

**Privacy**

The privacy of your personal information has always been important to us. To learn more about how we collect, keep and use your personal information, please obtain a copy of our privacy statement by visiting our website at [www.sampfordixl.com.au](http://www.sampfordixl.com.au) or by contacting us via email on [info@sampfordixl.com.au](mailto:info@sampfordixl.com.au) or by telephone on 1300 727 421.

**TEMPLATE FOR CUT OUT**



Complete and keep the following information as it is vital for warranty claims and service calls. Ensure you maintain proof of purchase including date.

**DO NOT SEND THIS CARD TO IXL.**

Cat./Model Number .....

Serial Number.....

Date purchased...../...../.....

Purchased from .....

Installed by.....