

# Installation Instructions

## Trombone Door

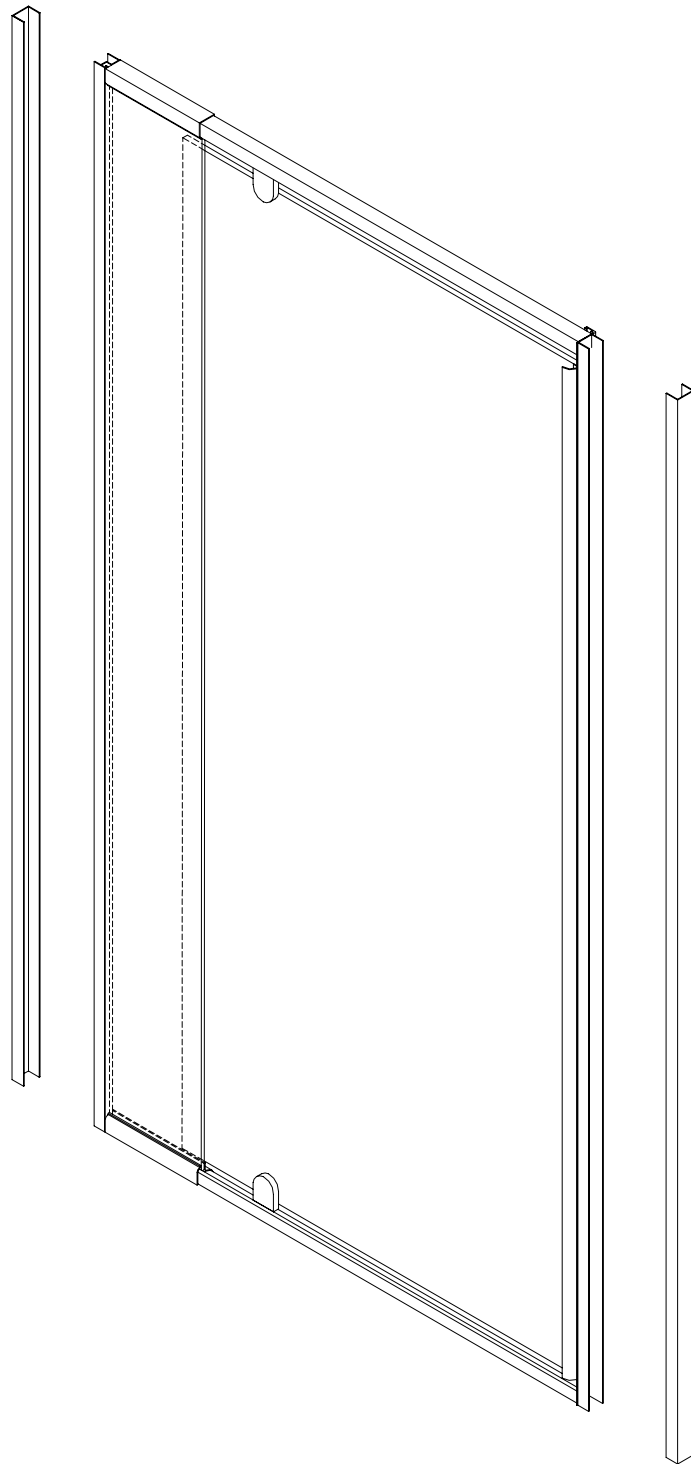

**Please read these Instructions carefully**

## Specifications

Description	Minimum shower door width	Maximum shower door width
Trombone P640 Red	640mm	700mm
Trombone P700 Green	700mm	760mm
Trombone P760 Yellow	760mm	840mm
Trombone P840 Purple	840mm	940mm
Trombone P940 Orange	940mm	1000mm

## Parts List

No.	Description	Qty
1	Wall Receiver	2
2	Door Assembly	1
3	Drip Seal	1 m length

## Installation Components

- White NG Silicone sealant
- No.6x10 Stainless Steel Screws (8)
- No.6x 38 Stainless Steel Screws (6)
- Screw Cover Caps - white (8)
- Drip Seal (1m length)

## Tools and Materials Required

- Drill
- No.1 Sq Drive Bit
- Spirit Level
- Pencil
- Tape Measure
- Flat Bladed Screwdriver
- 3.0 mm Drill Bit
- 4.5 mm Drill Bit
- Caulking Gun
- Cleaning Cloth
- Masking Tape

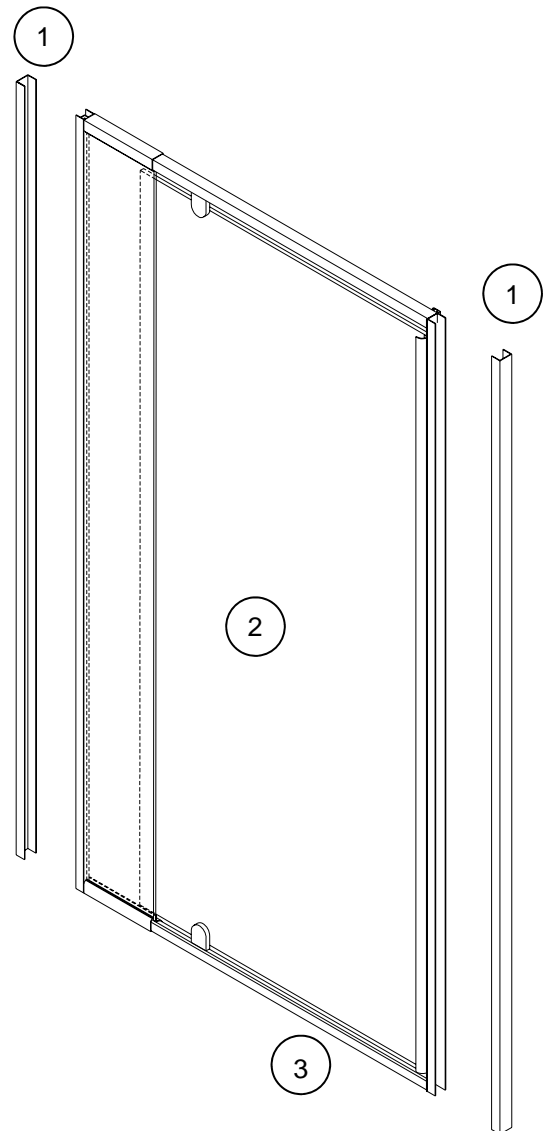

The Trombone Door can be installed either left or right hand hinged by simply rotating 180 degrees.

**Important : The Door must always open outwards**

## Step 1 Installing the Wall Receivers

Place the Wall Receiver on the shower step. Using a spirit level ensure the Wall Receiver is plumb. Mark the position of the Wall Receiver on the wall. Repeat for the opposite side

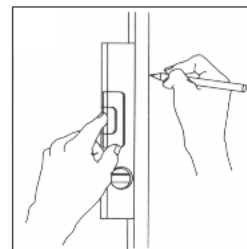

Pre drill three equally spaced clearance holes (i.e. top, bottom and centre) in the Wall Receivers using a 4.5mm drill bit. Reposition the Wall Receivers onto the wall. Drill into the wall through the clearance holes using a 3.0mm drill bit.

**N.B.** The holes preferably locate into a stud or nog. As an alternative, a toggler system can also be used.

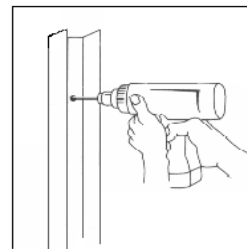

Apply Silicone into the screw holes and secure the Wall Receivers to the walls using the No.6 x 38mm stainless steel screws.

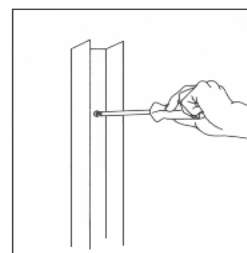

## Step 2 Installing the Trombone Door

Slide the Trombone door assembly together so it is at its minimum width

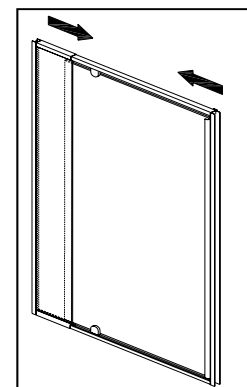

Determine which side the Trombone Door is to be hinged ensuring that the door opens outwards. Lift the Trombone Door onto the shower step and fully insert one side into a Wall Receiver. Expand the Door out so it fully engages into the opposite Wall Receiver.

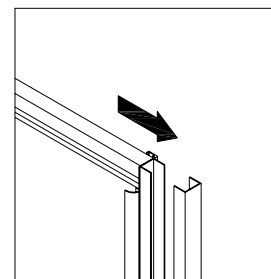
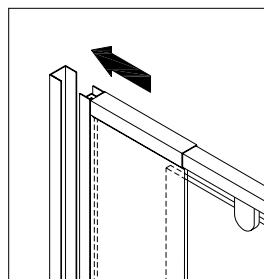

Check that the Door Jambs are plumb

From the inside of the shower fix the Door to the Wall Receivers by drilling three 3mm holes down the Wall Receivers (top, bottom and centre). Drill through the Wall Receivers into the Door Jamb profiles.

Secure in place using No.6 x 10mm stainless steel screws. Cover the screw heads with the cover caps.

Repeat for opposite side.

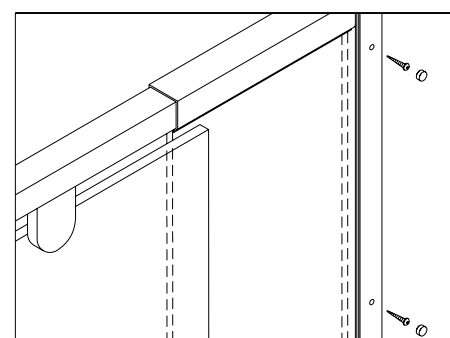

From the inside of shower

### Step 3 Securing the Head and Sills

From the inside of the shower drill a 3.0mm hole approximately 25mm in from the end of the Female Head and Sill sections and into the Male Head and Sill sections.

Secure the sections together using No.6 x 10 Stainless steel screws. Cover the screws heads with the cover caps.

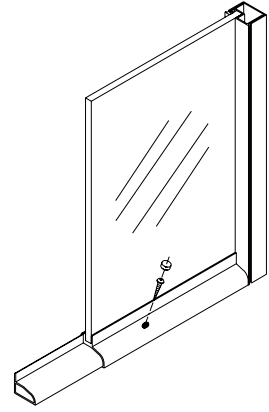

### Step 4 Adjusting the Trombone Door Glass

Slide the outside Clamp Block Covers off the Pivot Clamp. Using a flat bladed screwdriver, adjust the door glass as required, by loosening the screws on each pivot block. Ensure that;

- The Magnetic door closing strips are aligned
- The lower edge of the Door glass is parallel to the Door Sill

Once the door adjustment is complete ensure the screws are retightened and reinstall the Clamp Block Covers

Trim and fit the Door Drip seal. The vertical blade of the drip seal will face to the inside of the shower

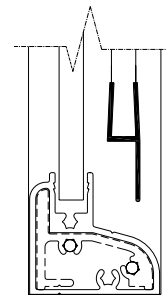
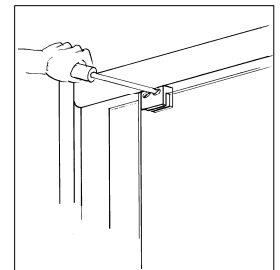
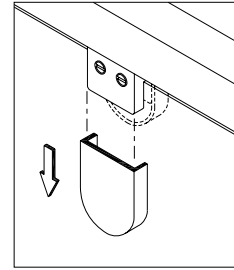

Inside of shower

### Step 5 Sealing the Trombone Door

Ensure all surfaces are cleaned with dry clean cloth.

From the **OUTSIDE ONLY**

- Seal Trombone Door to the Shower Step
- Seal the full length of the Wall Receivers to the Wall Liner

**Note** MASKING the area to be sealed will give a superior finish

**IMPORTANT: DO NOT** apply sealant to the inside of the shower

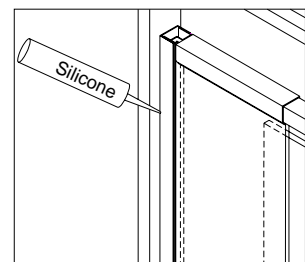
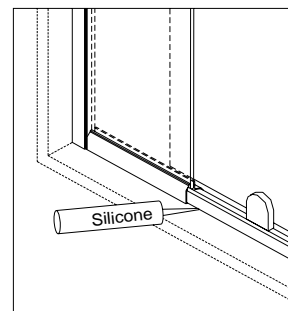

Telephone: (09) 444 3780  
Facsimile: 0800 88 00 11  
Email: info@clearlite.co.nz  
Website: www.clearlite.co.nz