

SPECIFICATION SHEET

Skye 1200mm 4 Drawer Wall Vanity



Features

- Wall Hung
- Full Extension Soft Close Drawers
- Cabinet:
White - 2-Pack Urethane on MRF
Colour - Laminate Finish
- Slab Top Options:
20mm Quartz Top
35mm StoneCast Top
- Dimensions: H670 x W1200 x D465

*Note: Vessel basins are purchased separately.
Visit www.newtech.co.nz for full range of vessel basin options.*

Cabinet Options



Winter Birch
97414WB



Nordic Ash
97414NA



Californian Oak
97414CA



Sweet Maple
97414SM



Roasted Walnut
97414RN

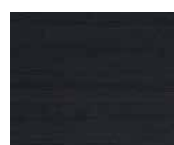

Charred Elm
97414CE

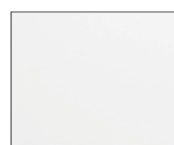

Gloss White
97414GW

StoneCast Slab Top Options

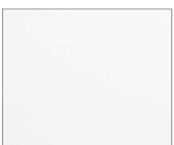

Gloss White
SC

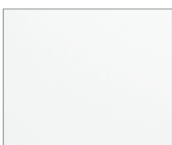

Matte White
SCMW

Quartz Slab Top Options

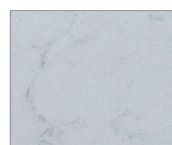

Himalaya
HY

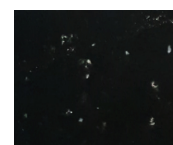

Midnight Stone
MS

Note: To order a Slab Top, add the slab top code to the cabinet code.

Technical Details

Note: All measurements shown are in millimetres. Sizes are nominal.

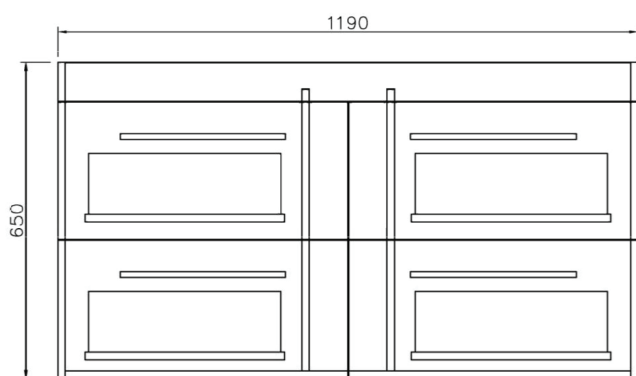

FRONT VIEW

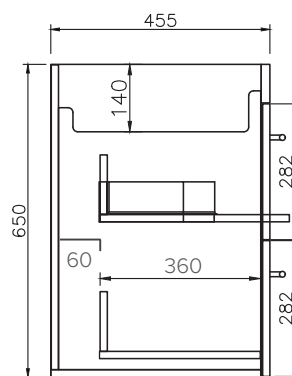

SIDE VIEW

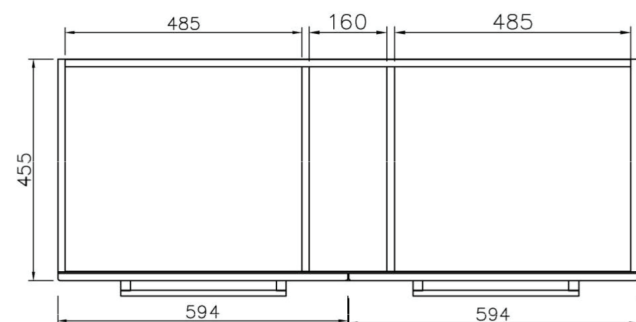

TOP VIEW

SPECIFICATION SHEET

Slab Top Options

StoneCast Slab Top 1200

W1200 x D465 x H20

Gloss White - SC

Matte White - SCMW

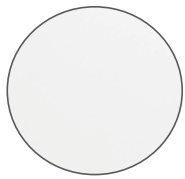
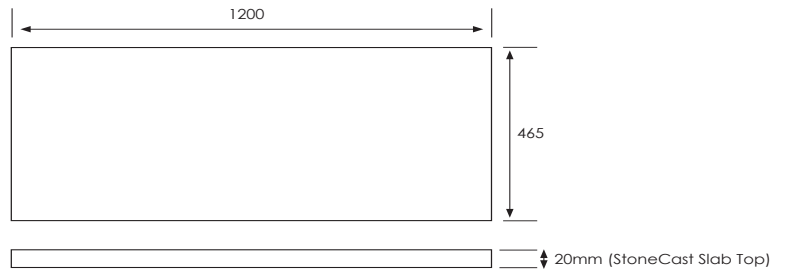
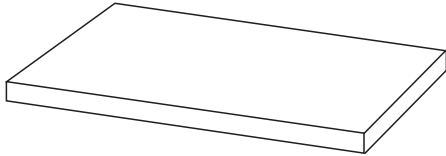

Gloss White



Matte White

Quartz Slab Top 1200

W1200 x D465 x H20

Midnight Stone - MS

Himalaya - HY

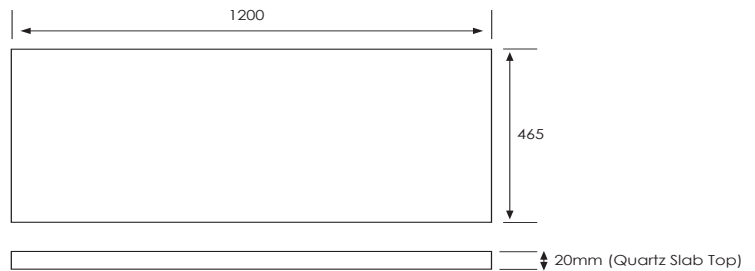
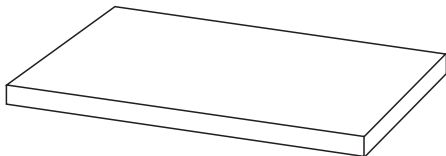

Midnight Stone

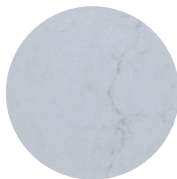

Himalaya

Tap Hole Position

Tap hole position must be specified

- NTH** No Tap Holes
- CTH** Centre Tap Holes
- LTH** Left Tap Holes
- RTH** Right Tap Holes
- ITH*** Inside Tap Holes
- OTH*** Outside Tap Holes

*only applicable with double basins