

# Outdoor Shower

## Wall Mounted Outdoor Shower

aquatica

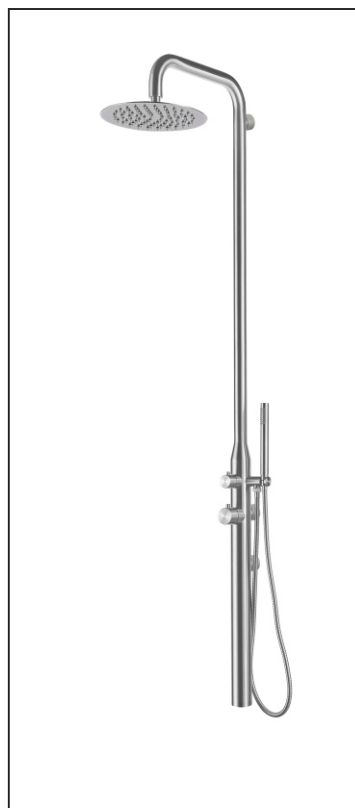
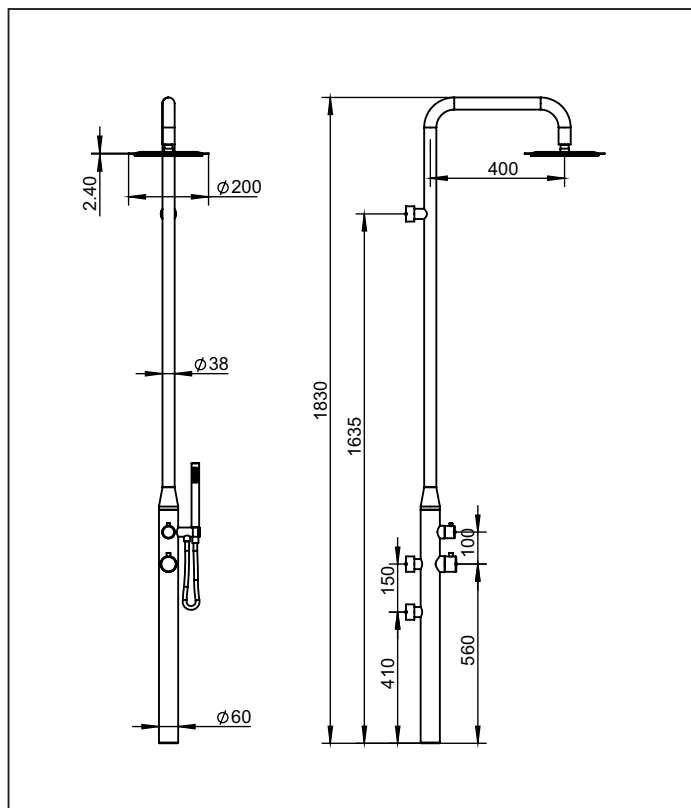

### Code: OUT SHC WALL

**Finish:** 316 Stainless Steel

**Water Outlet :** **Rain Head:** 200mm Diameter  
Replaceable nipples

**Hand Shower:** Single spray  
Spray pattern @ Head = 45 x 15mm (Rectangle Pattern)  
Spray pattern @ 500mm from Head = 90 x 45mm (Rectangle Pattern)

**Hose:** **Construction:** Stainless Steel Wide Bore  
**Length:** 1.5m

**Water Inlet :** **Rain Head:** 1/2" BSP female thread  
**Hand Shower:** 1/2" BSP Male thread  
**Spigot inlets:** 1/2" BSP male. Spigot = 28mm Diameter with 6mm adjustment.

**Divertor :** Center = off  
90 Degree Counter Clockwise = Rain Head  
90 Degree Clockwise = Hand Shower  
Note: Cannot have both outlets on together

**Cartridge :** 35mm Han-Yo

**Mounting:** Hot and Cold outlets from the wall need to be 1/2" BSP female  
Recommended outlet position: 900mm from ground (Cold) and 1050mm (Hot)

**Flow Control:** PCW 9's fitted in both Handshower and rainhead for regulated flow with main pressure system

**Features:** Increased corrosion resistance over standard 304 stainless steel  
Swivel eccentrics to compensate for any small positioning errors

### Suitable for mains pressure only

Recommended Operational Pressure Range: 150 - 600 kPa  
Maximum Operating Temp: 80°C Never to Exceed: 1000 kPa



KIWI OWNED COMPANY

NZ

DESIGNED  
ASSEMBLED  
TESTED



### Aquatica NZ Limited

9 Saunders Place,  
Avondale, Auckland.  
Tel: 09-828 2068,  
Fax: 09-828 2069  
Email: [info@aquatica.co.nz](mailto:info@aquatica.co.nz)  
or visit our website:  
[www.aquatica.co.nz](http://www.aquatica.co.nz)

© copyright Aquatica 2019

**Please note:** Specifications are subject to change without notice. It is the responsibility of the installer to check the measurements of the physical product before installation