

ProFinish™

Recessed Tile Shelf Installation Instructions

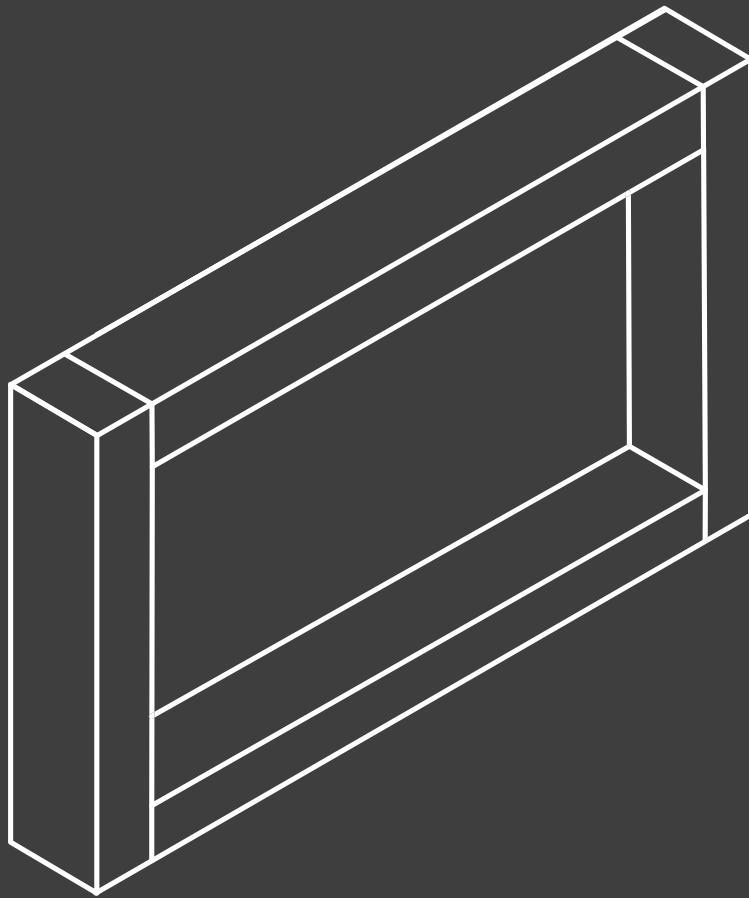

www.profinish.co.nz

NEWLINE
for a lifetime!

Recessed Tile Shelf Installation Instructions

COMPONENTS

- ProFinish Recessed Tile Shelf Unit
- Glue

The ProFinish shelf can be fitted using two different methods:

1. Gluing directly onto the rear surface of the compressed sheet wall liner before the liner is installed (Figure 1)
2. Gluing to nogs and studs first and then onto the rear of slateboard wall liner when fitting (Figure 2)

METHOD 1

Figure 1

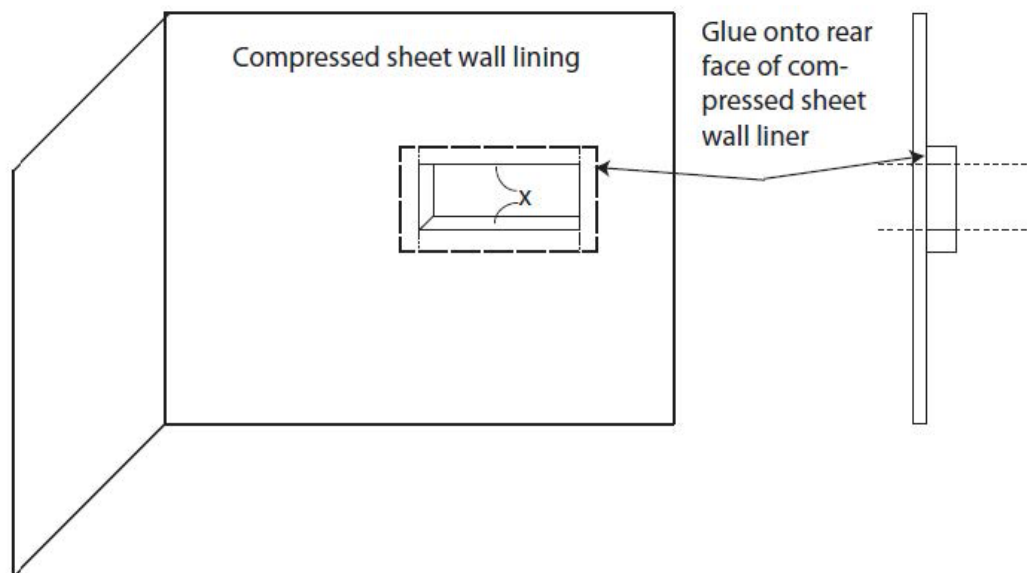

STEP 1 Confirm position of the shelf on the wall.

STEP 2 Cut a hole in the compressed sheet wall liner to suit the internal dimensions of the shelf.

STEP 3 Using the glue provided, glue the shelf onto the rear surface of the compressed sheet wall liner.

STEP 4 Hold in place with tape until glue has cured.

STEP 5 Once the glue has dried the wall sheet is ready to fit and waterproof.

STEP 6 Waterproof with any of the approved membranes listed on back page.

STEP 7 Using this installation method nogs are not required to support the recessed shelf.

METHOD 1

Figure 2

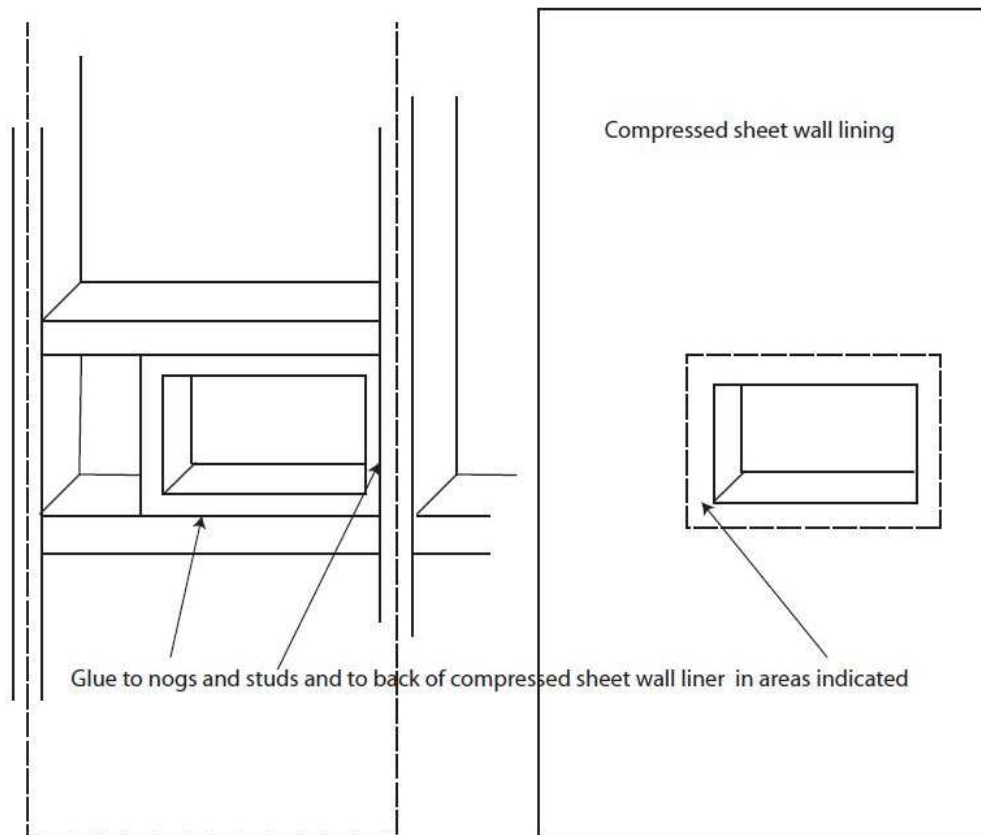

STEP 1 Consult with tile layer to determine the best position for shelf to match final grout lines.

STEP 2 Glue shelf to nogs and/ or studs (can be screwed to hold firm while glue cures).

STEP 3 Glue front face of shelf onto rear side of compressed sheet tile underlay wall liner when liner is fixed to the wall.

STEP 4 Waterproof with any of the approved membranes as per attached list.

WATERPROOFING

Waterproof Membranes

Select and apply your choice of waterproofing membrane according to the manufacturer's instructions. Listed in Table 1 are waterproofing manufacturers who have approved their product for application to the ProFinish shelf and their warranty's. Please ensure your waterproofer or tiler uses one of these products (refer to back page). Many of the products listed are available for D.I.Y application, we recommend that you contact one of the certified contractors listed, to apply the waterproofing (most manufacturer's warranties are voided if an approved person is not used to apply them).

ProFinish™ Tile Tray Waterproofing

WATERPROOFING

- The Independent Waterproofing Companies listed below have tested their systems and procedures on Newline Profinish Tile Trays. This represents years of proven track record.
- At the time of publication all Waterproofing Systems hold a BRANZ Appraisal.
- All the Waterproofing Systems listed have an aligned Tiling Systems. You must use the associated Waterproofing & Tiling system for compatibility, performance and accountability.
- A Producer Statement must be provided to the Council Authority and Owner detailing the Waterproofing applicator ID or Code. As an appendage also include the tiling system utilised.
- Applicators must be trained and hold current Accreditation with the respective system being utilised for the Warranty to be valid. We advise you to ask for these credentials.

COMPANY	PRIMER	PRODUCTS	CONTACT	WARRANTY
ARDEX	Prep: Wipe down with damp cloth - No primer	1. ARDEX WPM 155 Rapid (1 Part Poly- Acrylic) 2. Ardex Superflex WPM 002 (2Part) 3. ARDEX WPM 750 WeldTec Undertile Sheet Membrane*	Ronald Rose 027 838 5691 ronald.rose@ardexnz.com	15years *20years
DAVCO Tilemax Ltd	Davco Primex	1. Davco K10 Plus - Polyurathane (Coat Primex within 24 hrs) 2. Davco K10 Rapid	Isaac Gordan 022 127 7694 isaac@tilemax.co.nz	15 years
DRIBOND CONSTRUCTION CHEMICALS	Primax Bonding slurry - Kemcrete mixed 50/50 with cement or Gripflex	1. Hydrathane 2. Liquid Flash 2- Pack 3. Reomat b/breaking Tapes	Steve Plester 022 1205416 sp.conchem@xtra.co.nz	15years
LADICRETE GLOBAL TILE	Prep: as instructions No Primer	Hydro Ban SBR	Chris Anderson 021 784 162 Chris@globaltile.co.nz	15years
MAPEI	Ecoprim Grip (1part) Magelastic SP (2 part)	1. Mapelastic AquaDefence 2. Mapegum WPS 3. Mapelastic Smart (2part)	Heidi Clark 027 6455 122 heidi.clark@mapei.co.nz	15 years
SIKA (NZ)	Per Instructions	Sikalastic-152 (2 Part) Sikalastic-220W	Andy Williams 09 820 2900 021 421 084 williams.andy@nz.sika.com	15 years
CTA	Prep N Prime	Aquablock SBR Aquablock WPU Aquablock (2 Part)		
Tiling Trade Supplies T/A Technokolla NZ	Prep: Clean and Vac surface. Technokolla 101	1. Technokolla RL80 SeamTape joins Rasolastic Advance. Two Part 2. Strataflex & Rasogum over laps	Dave Boyes 0275 635 891 dave@technolla.co.nz	15 years

- Newline warrants the performance and integrity of the Profinish Tile Shower Base for 20 years. Non-conformity to installation instructions has the risk of failure.
- All Waterproofing and Tile Installation must be installed as per manufactures Specifications as any deviation from the instructions may result in a performance failure.
- All Tiling must follow BRANZ Good Tiling Practice.

* This document is current as of 10 December 2018.

NEWLINE
for a lifetime!

Head Office: 3 Hynds Road, Greerton, Tauranga 3112

Email: info@newline.co.nz

Freephone: 0508 639 5463 Phone: 09 444 2053 Fax: 09 443 0044

www.newline.co.nz