

SP150D4FLDB/SP150D4FLDBM
SPLASH
 1500, 4 DRAWER, DOUBLE BOWL

vcboc
 FOR BATHROOMS

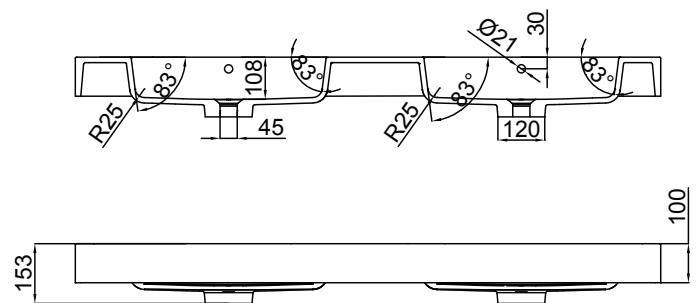

Splash Basin

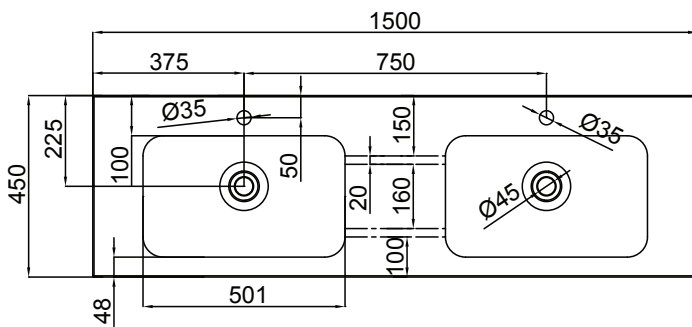

NB: Drawings indicate the technical measurements only and is not a reflection of how the unit will look.

SP150D4FLDB/SP150D4FLDBM
SPLASH 1500, 4 DRAWER, DOUBLE BOWL

- Dimensions - W 1500mm H 900mm D 450mm
- Polymarble top. Polymarble is a composite product and is very durable.
- Paint - The paint used on our products is polyurethane or UV based. It is five times harder and more durable than lacquer finishes. White only.
- TIMBER EFFECT (Melamine)- Our woodgrain melamine is a low pressure laminate. Two colours are available Charred Oak and Driftwood.

FINISHES

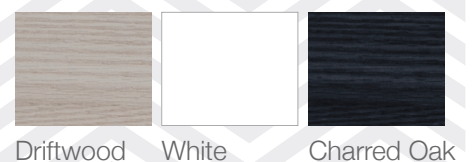

SP150D4FLDB/SP150D4FLDBM
SPLASH
1500, 4 DRAWER, DOUBLE BOWL



Splash Cabinet

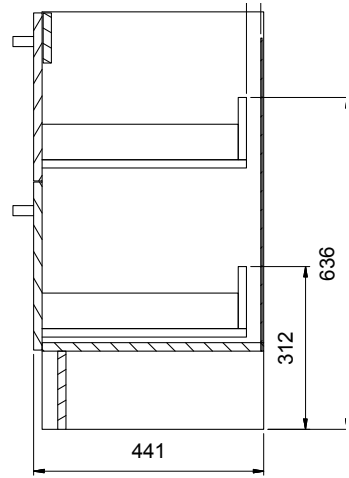
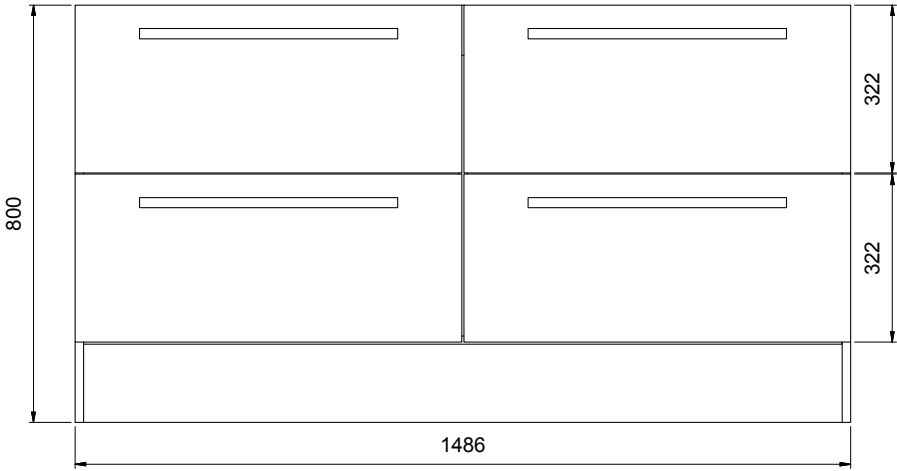

SPLASH Floor Drawer Units Side View

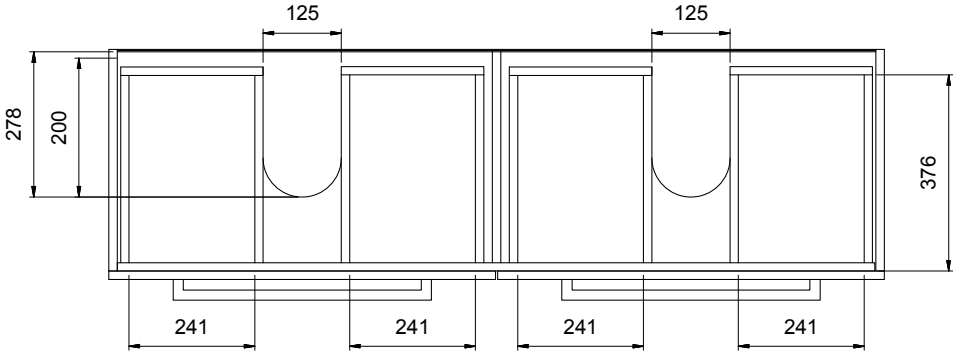

SP150D4FLDB Top View Showing Drawers

NB: Drawings indicate the technical measurements only and is not a reflection of how the unit will look.