

# AQUERO SLIDING DOOR SHOWERS

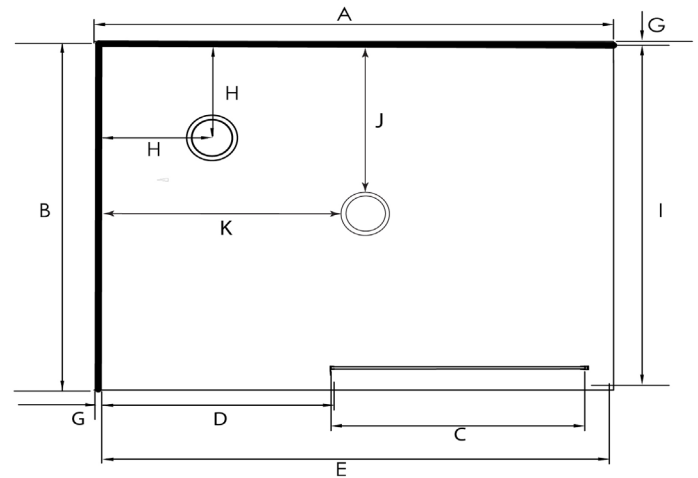

Pictured - Aquero 1200 x 900 2 Panel Sliding Door  
Right Hand Tray Configuration Flat Wall Silva  
**SKU S12X9AQRSRHSIFWZ**



## DESCRIPTION

The Aquero Range of 2 Panel Sliding Door Showers can be purchased as a complete shower cubicle including Acrylic Tray, Wall Liner and Door Pack.

The Door Pack and Tray can also be purchased as individual items for installation on a tiled floor and/or wall.

SEE TILE SHOWER LAYOUT FOR SETOUT DIMENSIONS

The door is reversible - and closes to the finished wall.

## FEATURES

- Total OVERALL height 2020mm
- Low profile tray with 40mm upstand
- 1950mm high glass
- 6mm Safety Glass
- Door is reversible (can open from left to right and right to left)
- Extrusions allow for adjustment to wall and floor
- High quality hardware

## LEGEND

Dimension	Description	Shower Size	
		1200x800	1200x900
A	Tray Length External Dimension	1200mm	1200mm
B	Tray Depth External Dimension	800mm	900mm
C	Door Opening Dimension +/- 10mm	560mm	560mm
D	Small Return Panel Dimension	542mm	542mm
E	Door Panel Dimension	1186mm	1186mm
F	Large Return Panel Dimension	780mm	880mm
G	Gib Board + Glue + Liner Thickness	13mm	13mm
H	Corner Waste Position (from Framing)	250mm	250mm
I	Return Panel Dimension	770mm	870mm
J	Centre Waste Position	N/A	450mm
K	Centre Waste Position	N/A	600mm

## ORDERING CODES

Product Description	SKU CODE	
	1200 x 800	1200 x 900
Complete Cubicle White Flat Wall Left Hand	S12X8AQLSHWHFWZ	S12X9AQLSHWHFWZ
Complete Cubicle White Flat Wall Right Hand	S12X8AQRHWHFWZ	S12X9AQRHWHFWZ
Complete Cubicle White Moulded Wall Left Hand	S12X8AQLSHWHMWZ	S12X9AQLSHWHMWZ
Complete Cubicle White Moulded Wall Right Hand	S12X8AQRHWHMWZ	S12X9AQRHWHMWZ
Complete Cubicle Silva Flat Wall Left Hand	S12X8AQLSHSIFWZ	S12X9AQLSHSIFWZ
Complete Cubicle Silva Flat Wall Right Hand	S12X8AQRHSIFWZ	S12X9AQRHSIFWZ
Complete Cubicle Silva Moulded Wall Left Hand	S12X8AQLSHSIMWZ	S12X9AQLSHSIMWZ
Complete Cubicle Silva Moulded Wall Right Hand	S12X8AQRHSIMWZ	S12X9AQRHSIMWZ
Tray Only Corner Waste White Left Hand	TFS12X8LHCNR	TFS12X9LHCNR
Tray Only Corner Waste White Right Hand	TFS12X8RHCNR	TFS12X9RHCNR
Tray Only Centre Waste White Left Hand	N/A	TFS12X9LHCW
Tray Only Centre Waste White Right Hand	N/A	TFS12X9RHCW
Liner Only Flat Wall 1950mm High 2 Sided White	LB12X8FW2S195	LB12X9FW2S195
Door / Return Pack 1950mm High White LH/RH	DG12DX8RWH195	DG12DX9RWH196
Door / Return Pack 1950mm High Silva LH/RH	DG12DX8RS195	DG12DX9RS195

## WARRANTY INFORMATION

All bathroomware products supplied by Nouera Shower Systems carry our Quality Assurance and Product Warranty. We use the highest quality materials available and manufacture these in accordance with New Zealand specifications and requirements to ensure that all products are fit for the intended purpose for which they are designed. Our customers peace of mind is of paramount importance to us.

### Warranty Periods

Showers	10 years
Drop In baths	10 years
Shower Screens and Doors	10 years
Black Coating on Framework	5 years
Freestanding Baths	5 years
Dezine Range Showers	5 years
Accessories	2 years

### Warranty Exclusions

The product must be installed according to the instructions supplied.

The water supply temperature applied to the product must not exceed 55 degrees Celsius.

Commercial applications (where products are installed in a building where occupancy is via a commercial arrangement i.e. rental property, hotel, hostel etc.) are restricted to a 2 year warranty on all products.



## PRODUCT MAINTENANCE

Bathroom products are used often and the following is our suggestion on how to clean and care for them.

### Shower Wall

We use Durosan premium quality sanitaryware grade Acrylic. It is, by design, very robust and chemical resistant. A soft damp cloth with non-abrasive cleaners should be used. Use only non-abrasive cleaners that are recommended for acrylic products.

### Shower Tray and Bath

We manufacture our Shower Trays and Baths using a Solid Acrylic Surface. Most other shower trays are manufactured using a veneer acrylic surface. The great advantage is that small scratches can be removed easily by using fine cutting compound. Again the same basic cleaning methods as the wall are recommended.

### Shower Doors and Glass

All glass is compliant to AS/NZS 2208. We suggest that the glass surfaces are wiped down or squeegeed following use to remove excess water. For best results use a trusted glass cleaner.

### Metal Framework

Should be cleaned using a soft damp cloth with non-abrasive cleaner. Note that on round showers, the bottom rollers are easy release for ease of cleaning. If chemical spray cleaners are used, avoid direct contact with the rollers and guides and ensure the shower is rinsed off to avoid residue build up.

### Weather Seals and Drip Strips

Can be removed if required for cleaning, and can be replaced when they no longer look their best. Refer to the spare parts and accessories section of our website for more details.

**Note - If the Glass has been treated follow specific cleaning instructions from the system provider.**